

Data sheet - Support roller STO 35TN (crowned, with inner ring)

Designation	STO 35
Type	crowned
D [mm]	72
d [mm]	35
F, Fw * [mm max.]	42
B1 [mm]	20
B [mm]	19,8
d1 [mm]	50
r [mm]	0,6
Dynamic load Crw [N]	26000
Static load C0rw [N]	41000
Speed limit [min-1]	2200

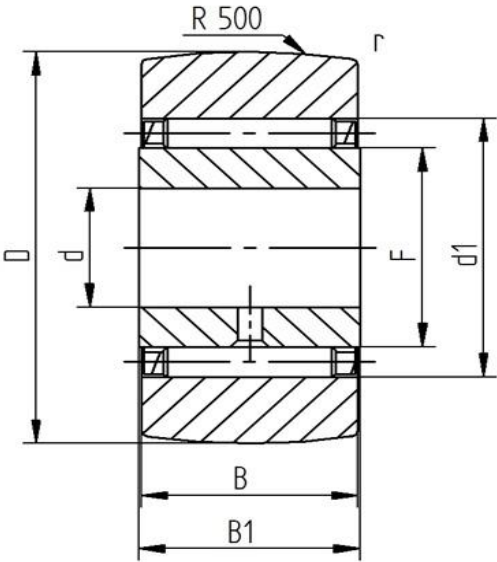

Every specification has been edited and verified carefully. STI Bearings GmbH assumes no liability for potential errors or incompleteness. Technical modifications are subject of changes.
© 2020 by STI Bearings GmbH
Reproduction, even excerpts, only with our approval.